

自润滑和免维护滑动轴承

JF 标准公制轴套 JF Normal Metric Bushing

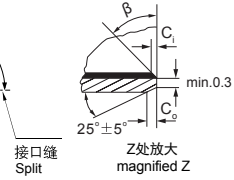
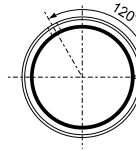
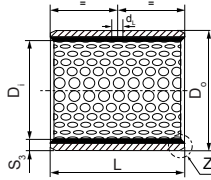
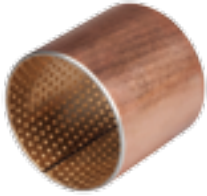

内外倒角 ID and OD chamfers

S_3	C_0	C_1	β
0.75	0.5 ± 0.3	0.25 ± 0.2	$35^\circ \pm 5^\circ$
1.00	0.6 ± 0.3	0.30 ± 0.2	$35^\circ \pm 5^\circ$
1.50	0.7 ± 0.3	0.50 ± 0.3	$35^\circ \pm 5^\circ$

S_3	C_0	C_1	β
2.00	1.2 ± 0.4	0.50 ± 0.3	$30^\circ \pm 5^\circ$
2.50	1.8 ± 0.6	0.60 ± 0.3	$45^\circ \pm 5^\circ$

单位unit:mm

内径 D_i ϕd	外径 D_o ϕD	轴径(h8) Shaft D_s	座孔(H7) Housing D_{i1}	压装后 内孔公差 Arter fixed $D_{i,a}$	配合间隙 Clearance C_0	壁厚 Wall thickness S_3	油孔 Oil hole d_l	长度 L $^{0}_{-0.40}$							
								10	15	20	25	30	40	50	
10	12	10 -0.022	12 $+0.018$	$+0.148$ $+0.010$	0.170 0.010	0.995 0.935	4	1010	1015	1020					
12	14	12 -0.027	14 $+0.018$					1210	1215	1220					
14	16	14 -0.027	16 $+0.018$					1410	1415	1420					
15	17	15 -0.027	17 $+0.018$					1510	1515	1520					
16	18	16 -0.027	18 $+0.018$					1610	1615	1620					
18	20	18 -0.027	20 $+0.021$					$+0.151$ $+0.010$	0.178 0.010	1.490 1.430	6	1810	1815	1820	1825
20	23	20 -0.033	23 $+0.021$	$+0.161$ $+0.020$	0.194 0.020	2010	2015	2020	2025						
22	25	22 -0.033	25 $+0.021$			2210	2215	2220	2225						
24	27	24 -0.033	27 $+0.021$			2410	2415	2420	2425			2430			
25	28	25 -0.033	28 $+0.021$				2515	2520	2525			2530			
26	30	26 -0.033	30 $+0.021$	$+0.181$ $+0.040$	0.214 0.040	1.980 1.920	8	2615	2620			2625	2630		
28	32	28 -0.033	32 $+0.025$	$+0.185$ $+0.040$	0.218 0.040			2815	2820			2825	2830	2840	
30	34	30 -0.033	34 $+0.025$					3015	3020			3025	3030	3040	
32	36	32 -0.039	36 $+0.025$					3215	3220			3225	3230	3240	
35	39	35 -0.039	39 $+0.025$						3520			3525	3530	3540	3550
38	42	38 -0.039	42 $+0.025$	0.224 0.040				3820	3825	3830	3840	3850			
40	44	40 -0.039	44 $+0.025$					4020	4025	4030	4040	4050			

JF 标准公制轴套
JF Normal Metric Bushing



内径 D_i ϕd	外径 D_o ϕD	轴径(h8) Shaft D_s	座孔(H7) Housing D_H	压装后 内孔公差 Arter fixed D_{ia}	配合间隙 Clearance C_o	壁厚 Wall thickness S_s	油孔 Oil hole d_L	长度 L $\begin{smallmatrix} 0 \\ -0.40 \end{smallmatrix}$									
								25	30	40	50	60	80	90	100		
45	50	45 -0.039	50 +0.025	+0.225 +0.080	0.264 0.080	2.460 2.400	8	4525	4530	4540	4550						
50	55	50 -0.039	55 +0.030	+0.230 +0.080	0.269 0.080			5030	5040	5050	5060						
55	60	55 -0.046	60 +0.030		5530			5540	5550	5560							
60	65	60 -0.046	65 +0.030		6030			6040	6050	6060							
65	70	65 -0.046	70 +0.030		6530			6540	6550	6560							
70	75	70 -0.046	75 +0.030	7030	7040			7050	7060	7080							
75	80	75 -0.046	80 +0.030	7530	7540			7550	7560	7580							
80	85	80 -0.046	85 +0.035	+0.235 +0.080	0.281 0.080		8030	8040	8050	8060	8080	8090					
85	90	85 -0.054	90 +0.035		8530		8540	8550	8560	8580	8590	85100					
90	95	90 -0.054	95 +0.035		9040		9050	9060	9080	9090	90100						
95	100	95 -0.054	100 +0.035		9550		9560	9580	9590	95100							
100	105	100 -0.054	105 +0.035		10050		10060	10080	10090	100100							
105	110	105 -0.054	110 +0.035		10550		10560	10580	10590	105100							
110	115	110 -0.054	115 +0.035	+0.240 +0.080	0.303 0.080		9.5	11050	11060	11080	11090	110100					
115	120	115 -0.054	120 +0.035			11550		11560	11580	11590	115100						
120	125	120 -0.054	125 +0.040			12050		12060	12080	12090	120100						
125	130	125 -0.063	130 +0.040			12560		12580	12590	125100							
130	135	130 -0.063	135 +0.040			13060		13080	13090	130100							
135	140	135 -0.063	140 +0.040			13560		13580	13590	135100							
140	145	140 -0.063	145 +0.040			14060		14080	14090	140100							
150	155	150 -0.063	155 +0.040	15060	15080	15090	150100										

注：内孔公差是轴套压入 0 位座孔时的公差

Note: In addition to the above specifications of size, manufactured according to customer drawings .

JF 标准公制翻边轴套 JF Normal Metric Flange Bushing

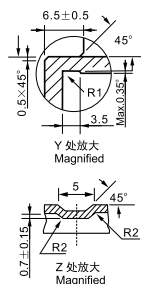
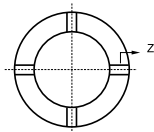
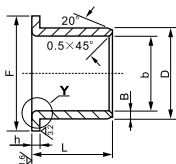

单位unit:mm

规格型号 Type	F	D	d	L	h	B
4040	60	46	40	39.5	3.5	3.0
4035	62	47	40	35	3.5	3.5
4055	68	55	45	55	3.5	5.0
5040A	72	57	50	40	3.5	3.5
5040B	70	57	50	40	3.5	3.5
5050	70	57	50	50	3.5	3.5
5460	92	60.6	54	60	3.5	3.3
6053	83	67	60	53	3.5	3.5
6060	87	67	60	60	3.5	3.5
6065	77	67	60	65	3.5	3.5
6060A	88	68	60	60	4.0	4.0
6060B	87	68	60	60	4.0	4.0
6465	102.6	70.4	63.5	65	3.5	3.5
6473	103	70.8	63.8	73	3.5	3.5
6553	85	72	65	53	3.5	3.5
6564	87	72	65	64	3.5	3.5
6575	108	72	65	75	3.5	3.5
7060	93	77	70	60	3.5	3.5
7090	108	80	70	90	5.0	5.0
7560	100	82	75	60	3.5	3.5
8060	105	87	80	68	3.5	3.5
8580	127	92	85	80	3.5	3.5
85103	128	92.6	85	103.5	3.5	3.8
89126	138	97.5	89.2	126.5	4.2	4.2
95127	144	105	95	127	5.0	5.0