

自润滑和免维护滑动轴承

SF-2 边界润滑轴套 SF-2 Marginal Lubricating Bushing

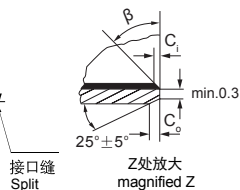
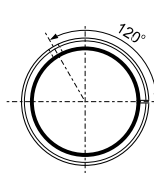
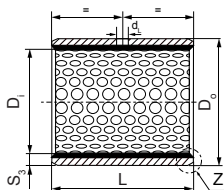

内外倒角 ID and OD chamfers

S_3	C_0	C_1	β	S_3	C_0	C_1	β
1.0	0.6 ± 0.3	0.30 ± 0.2	$30^\circ \pm 5^\circ$	2.00	1.2 ± 0.4	0.50 ± 0.3	$30^\circ \pm 5^\circ$
1.5	0.7 ± 0.3	0.50 ± 0.2	$30^\circ \pm 5^\circ$	2.50	1.8 ± 0.6	0.60 ± 0.3	$45^\circ \pm 5^\circ$

单位unit:mm

型号规格 Designation	轴径 Shaft D_s h8	座孔 Housing H7 D_H	(OD) 外径公差 Tolerance D_o	(ID) 压装后 内孔公差 After fixed D_{iA}	配合间隙 Clearance D_o	壁厚 Wall thickness S_3	油孔 Oil hole d_i	长度 $B_{0.40}^0$														
								10	15	20	25	30	35	40	45	50	60					
SF-2	10	-0.022	12	$+0.018$	12	$+0.065$ $+0.030$	10.108 10.040	0.130 0.040	0.980 0.955	4	1010	1015	1020									
SF-2	12	-0.027	14	$+0.018$	14	$+0.065$ $+0.030$	12.108 12.040				1210	1215	1220									
SF-2	14	-0.027	16	$+0.018$	16	$+0.065$ $+0.030$	14.108 14.040	0.135 0.040			1415	1420										
SF-2	15	-0.027	17	$+0.018$	17	$+0.065$ $+0.030$	15.108 15.040				1515	1520	1525									
SF-2	16	-0.027	18	$+0.018$	18	$+0.065$ $+0.030$	16.108 16.040				1615	1620	1625									
SF-2	18	-0.027	20	$+0.021$	20	$+0.075$ $+0.035$	18.111 18.040	0.138 0.040			1815	1820	1825									
SF-2	20	-0.033	23	$+0.021$	23	$+0.075$ $+0.035$	20.131 20.050	0.164 0.050			2015	2020	2025	2030								
SF-2	22	-0.033	25	$+0.021$	25	$+0.075$ $+0.035$	22.131 22.050	1.475 1.445			2215	2225										
SF-2	25	-0.033	28	$+0.021$	28	$+0.075$ $+0.035$	25.131 25.050				2515	2520	2525	2530								
SF-2	28	-0.033	32	$+0.025$	32	$+0.085$ $+0.045$	28.155 28.060	0.188 0.060				2820	2830									
SF-2	30	-0.033	34	$+0.025$	34	$+0.085$ $+0.045$	30.155 30.060	1.970 1.935		3020	3025	3030	3040									
SF-2	35	-0.039	39	$+0.025$	39	$+0.085$ $+0.045$	35.155 35.060	0.194 0.060		3520	3530	3535	3540									
SF-2	40	-0.039	44	$+0.025$	44	$+0.085$ $+0.045$	40.155 40.060			4020	4030	4040	4050									
SF-2	45	-0.039	50	$+0.025$	50	$+0.085$ $+0.045$	45.195 45.080	0.234 0.080		4520	4530	4540	4545	4550								
SF-2	50	-0.039	55	$+0.030$	55	$+0.100$ $+0.055$	50.200 50.080	0.239 0.080	2.460 2.415				5030	5040	5050	5060						
SF-2	55	-0.046	60	$+0.030$	60	$+0.100$ $+0.055$	55.200 55.080	0.246 0.080				5530	5540	5550	5560							
SF-2	60	-0.046	65	$+0.030$	65	$+0.100$ $+0.055$	60.200 60.080				6030	6040	6050	6060								

SF-2 边界润滑轴套
SF-2 Marginal Lubricating Bushing



型号规格 Designation	轴径 Shaft D h8	座孔 Housing H7 D _H	(OD) 外径公差 Tolerance D _O	(ID)压装后 内孔公差 After fixed D _{La}	配合间隙 Clearance D _b	壁厚 Wall thick- ness S ₃	油孔 Oil hole d _c	长度 L _{-0.40}											
								40	50	60	80	90	95	100	110	120			
SF-2	65 _{-0.046}	70 _{+0.030}	70 _{+0.030}	65.200 65.080				6540	6560										
SF-2	70 _{-0.046}	75 _{+0.030}	75 _{+0.030}	70.200 70.080	0.246 0.080	2.460 2.415	8	7040	7050	7080									
SF-2	75 _{-0.046}	80 _{+0.030}	80 _{+0.030}	75.200 75.080				7540	7560	7580									
SF-2	80 _{-0.046}	85 _{+0.035}	85 _{+0.035}	80.265 80.100	0.313 0.100			8040	8060	8080									
SF-2	85 _{-0.054}	90 _{+0.035}	90 _{+0.035}	85.265 85.100				8540	8560	8580									
SF-2	90 _{-0.054}	95 _{+0.035}	95 _{+0.035}	90.265 90.100				9040	9060	9080	9090								
SF-2	100 _{-0.054}	105 _{+0.035}	105 _{+0.035}	100.265 100.100	0.321 0.100				10050	10080	10095								
SF-2	105 _{-0.054}	110 _{+0.035}	110 _{+0.035}	105.265 105.100						10560	10580	10595		10510					
SF-2	110 _{-0.054}	115 _{+0.035}	115 _{+0.035}	110.265 110.110						11060	11080	11095		11010					
SF-2	120 _{-0.054}	125 _{+0.040}	125 _{+0.040}	120.270 120.110							12060	12080				12010			
SF-2	125 _{-0.063}	130 _{+0.040}	130 _{+0.040}	125.270 125.110							12560					12510			
SF-2	130 _{-0.063}	135 _{+0.040}	135 _{+0.040}	130.270 130.110						13050	13060	13080				130100			
SF-2	140 _{-0.063}	145 _{+0.040}	145 _{+0.040}	140.270 140.110	0.324 0.100					14050	14060	14080				140100			
SF-2	150 _{-0.063}	155 _{+0.040}	155 _{+0.040}	150.270 150.110		2.450 2.385	9.5			15050	15060	15080				150100			
SF-2	160 _{-0.063}	165 _{+0.040}	165 _{+0.040}	160.270 160.110						16050	16060	16080				160100			
SF-2	170 _{-0.063}	175 _{+0.040}	175 _{+0.040}	170.270 170.110						17050		17080				170100			
SF-2	180 _{-0.063}	185 _{+0.046}	185 _{+0.046}	180.270 180.110						18050	18060	18080				180100			
SF-2	190 _{-0.072}	195 _{+0.046}	195 _{+0.046}	190.276 190.110						19050	19060	19080				190100		190120	
SF-2	200 _{-0.072}	205 _{+0.046}	205 _{+0.046}	200.276 200.110	0.339 0.110					20050	20060	20080				200100		200120	
SF-2	220 _{-0.072}	225 _{+0.046}	225 _{+0.046}	220.276 220.110						22050	22060	22080				220100		220120	
SF-2	240 _{-0.072}	245 _{+0.046}	245 _{+0.046}	240.276 240.110						24050	24060	24080				240100		240120	
SF-2	250 _{-0.072}	255 _{+0.052}	255 _{+0.052}	250.282 250.110						25050	25060	25080				250100		250120	
SF-2	260 _{-0.081}	265 _{+0.052}	265 _{+0.052}	260.282 260.110						26050	26060	26080				260100		260120	
SF-2	280 _{-0.081}	285 _{+0.052}	285 _{+0.052}	280.282 280.110	0.354 0.110					28050	28060	28080				280100		280120	
SF-2	300 _{-0.081}	305 _{+0.052}	305 _{+0.052}	300.282 300.110						30050	30060	30080				300100		300120	